

Bell Hydromatics



Inline Flow Control Valves



Ordering Code

Model	LA - X X - X X / 50 X *				Desc.
Flow Control with check valve Omit sub-plate type 8 pipe type		Specification 6 6 (NG 6) 8 8 (NG 8) 8 8 (NG 8) 8 8 (NG 8) 8 8 (NG 8) 8 8 (NG 8) 8 8 (NG 8) 8 8 (NG 8) 8 8 (NG 8)		Remark Omit A type B B B type Serial Number Screw thread type M Screw thread BSP thread NPT thread SAE thread Opening pressure a 0.05 bar b 0.4 bar	

Dimensions

Inline Flow Control Valves

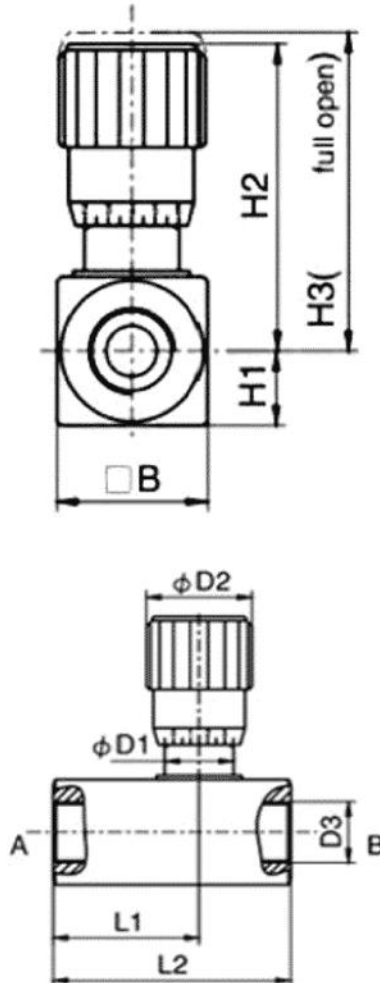

Specifications

Specification	Model	6	8	10	12	16	20	25	30	40
Maximum Pressure (bar)	315									
Maximum Flow (l/min)		14	40	60	85	175	200	300	400	600
Hydraulic Flow	Mineral Oil, phosphate-ester									
Fluid Temp. (°C)	-20~70									
Viscosity (mm ² /s)	2.8~380									
Cracking Pressure	a : 0.05 b : 0.4									
Weight (kg)		0.45	0.44	0.47	1.02	0.97	2.22	4.35	8.55	12.32
Symbol										

Model	"B	D1	D2	D3	H1	H2	H3	L1	L2
G6	28	19.3	30	G 1/8"	14	59.3	64.8	36	58
G8	28	19.3	30	G 1/4"	14	61.3	67.9	39	64
G10	28	19.3	30	G 3/8"	14	61.5	67.5	43	70
G12	38	24.2	37	G 1/2"	19	78.1	86.5	52	83
G16	38	24.2	37	G 3/4"	19	78.3	86.5	55.5	89
G20	48	35	48	G 1"	24	102.3	114.4	70.8	117
G25	60	50	48	G 1-1/4"	30	134.68	148.1	97	154
G30	70	70	80	G 1-1/2"	35	161.5	181.5	111	172
G40	90	71	80	G 2"	45	171.5	191.5	129	190